

OPERATORS AND PARTS MANUAL MODEL 355/2000 Slicer Seeder



MANUFACTURER OF OUTDOOR POWER EQUIPMENT

Products for Turf & Lawn care, Rental, Construction, Tree care, Wood Processing, Nursery & Farm Industries

Other Salsco Equipment

**3-1/2" - 18", Gas, Diesel, and P.T.O, Wood/Brush Chippers
Chipper Shredder Vacuum - Tailgate & Truckloader Vacuums up to 65 HP
Shaving Mills - Gas and Electric Greens Rollers**

***Quality of Workmanship, Innovative
Design, Built to Last!***

105 School House Road
Cheshire, CT 06410 U.S.A.
800-872-5726, 203-271-1682, 203-271-2596 (Fax)
sales@salsco.com, www.salsco.com

TABLE OF CONTENTS

MODEL 355/2000 SLICER SEEDER

COVER & TABLE OF CONTENTS.....Pages 1 – 2

STATEMENT OF FACT Page 3

SPECIFICATIONS & FEATURESPage 4

MACHINE REGISTRATIONPage 5

CAUTIONSPage 6

SAFETY & OPERATING INSTRUCTIONSPage 7

SERVICE & MAINTENANCE INSTRUCTIONSPages 8-11

PARTS DIAGRAMSPages 12-16

TORQUE CHARTSPage 17

WARRANTY POLICY/PROCEDUREPage 18

COPYOF WARRANTY CLAIM FORM.....Page 19

SERVICE SCHEDULE LOGPage 20

SALSCO, INC.
105 School House Road
Cheshire, CT 06410
800-872-5726, 203-271-1682
203-271-2596 (Fax)
www.salsco.com, sales@salsco.com

STATEMENT OF FACT

You have just purchased the highest quality, most maneuverable seeding machine, on the market today. This unit has the ability to meet exact seeding standards and perform for years with minimum downtime. **HOWEVER**, it cannot read nor will it understand this manual no matter how long you leave it on top of the machine.

It is your responsibility to read and understand this manual; it is also your responsibility to be certain this information is passed along to anyone who is expected to operate this equipment. Should you choose not to read, understand and pass along the information provided you, please expect equipment failure and possible injuries to persons around this equipment.

For the safety of the operator, it is **imperative** that this manual is carefully read and understood.

Once you have read this manual, it is your responsibility to be sure that all new operators read and understand this manual, especially all **cautions** stated on page 6.

As a manufacturer of equipment, we have a responsibility to design a safe piece of equipment. **NOTE:** The important safeguards and instructions in this manual are not meant to cover all possible conditions and situations that may occur. It must be understood that common sense, caution, and care are factors, which cannot be built into any product. These factors must be supplied by the person(s) caring for and operating this equipment.

ONLY YOU CAN PREVENT ACCIDENTS!!

THINK SAFETY

SPECIFICATIONS & FEATURES

DESCRIPTION

The Salsco Slicer Seeder Model 355/2000 is the only ALL Terrain* Slicer Seeder on the market today.

It has the ability to seed within a 25" radius and will handle inclines up to 40 degrees*. This unit will plant rows 2" apart creating a 20" seed bed with each pass.

The unit has the ability to slice and seed at the rate of 20,000 sq. feet per hour.

The slicer blades are adjustable to a maximum depth of 2 1/4". Please keep in mind that for the best germination seed should be set just below soil surface, approximately 1/4" depth. The seed passes from the hopper through a diamond shaped metering device and comes out alongside the slicer disc which is riding in the slit created by the Cutter Blade. The seed is then deposited in that slit. Due to our 2" center line of rows, 6-8 seeds per linear inch should be more than sufficient for proper seed bed.

The slicer discs are mounted on a pivoting hopper allowing them to follow the slit created by the slicer blades around a 25" radius.

This is a precision seeding machine and while we do make an attempt at advising on how to adjust the seed meter the best and most accurate way is described under "OPERATION & START UP INSTRUCTIONS".

*PLEASE REFER TO THE "CAUTIONS" SECTION OF THIS MANUAL.

DO NOT RUN MACHINE WITHOUT GUARDS IN PLACE

THINK SAFETY

MACHINE REGISTRATION

MANUFACTURED BY: SALSCO, INC.
105 School House Rd., Cheshire, CT 06410
800-872-5726, 203-271-1682, 203-271-2596 (Fax)
sales@salsco.com www.salsco.com

THIS MANUAL COVERS MODEL (s): 355/2000 SLICER SEEDER.

This company reserves the right to discontinue, add improvements to, or change the design of any model or product at any time without obligation to improve existing machines, either by changing the design or adding new parts.

It has been and will continue to be the policy of SALSCO to update existing machines at its own discretion. Whenever possible, new designs will be made in such a way that they can be "Retro Fit" if so desired.

Record in the space provided below the model and serial number of this unit. Please retain these numbers for future reference.

No parts orders will be accepted **WITHOUT MODEL NUMBERS OR PART NUMBERS**. All part numbers are listed in this manual.

Serial Number

Model Number

NOTE: Be sure to complete your warranty card. This will insure immediate processing of any warranty claims.

READ AND UNDERSTAND THIS MANUAL BEFORE STARTING THE MACHINE

1/06

CAUTIONS

THIS MACHINE CAN CAUSE SERIOUS INJURY. PLEASE READ AND UNDERSTAND ALL CAUTION NOTES. **NEVER** LEAVE MACHINE RUNNING WHILE UNATTENDED!!!

1. READ AND UNDERSTAND OWNER'S MANUAL.
2. DO NOT RUN WITHOUT GUARDS AND OTHER SAFETY COVERS ON MACHINE.
3. NEVER LEAVE MACHINE RUNNING WHILE UNATTENDED.
4. NEVER REACH UNDER OR INTO MACHINE FOR ANY REASON WHILE MACHINE IS RUNNING AS IT CAN CAUSE SERIOUS INJURY.
5. DO NOT LET ANYONE WALK NEXT TO OR IN FRONT OF MACHINE WHILE IT IS IN OPERATION.
6. NEVER RUN OVER ASPHALT OR CONCRETE OR ANY OTHER SURFACE THAT CANNOT BE SLICED WITH THE SLICER BLADES IN LOWERED POSITION.
7. BE SURE SLICER CLUTCH IS DISENGAGED BEFORE STARTING UNIT.
8. BE SURE DRIVE CLUTCHES ARE IN SQUEEZE POSITION AND THUMB LOCK IS ENGAGED BEFORE STARTING UP.
9. UNDER NO CIRCUMSTANCES, EVER ALLOW ANY PART OF YOUR BODY OR ANYONE ELSE'S BODY TO COME IN CONTACT WITH THE FRONT OF, UNDERNEATH SIDE OR INSIDE OF ANY PART OF THIS MACHINE AS IT WILL REMOVE ANY PART OF THE BODY THAT IS PLACED THERE!
10. ALWAYS REMOVE SPARK PLUG WIRE, MAKE SURE ENGINE SWITCH IS OFF, THROTTLE IS IN STOP POSITION, AND SHUT GAS OFF WHEN WORKING ON OR CHECKING THE INSIDE OF THE MACHINE.
11. NEVER RUN MACHINE WITHOUT CONNECTING ELECTRIC KILL SWITCH TO BELT OR BELT LOOP. THIS WILL SHUT DOWN THE MACHINE'S ENGINE SHOULD THE OPERATOR BECOME SEPARATED FROM THE MACHINE.
12. DO NOT REMOVE CAUTION DECALS.
13. SAFETY DECALS SHOULD BE REPLACED IMMEDIATELY AFTER REPAINTING OR WHEN THEY BECOME ILLEGIBLE. ****SEE NOTE BELOW****

****NOTE****

SAFETY IS A PRIME CONCERN AT SALSCO AND THE SAFETY DECALS ON YOUR MACHINE ARE A HIGHLY VISIBLE AND CONSTANT REMINDER TO ALL OPERATORS. REPLACEMENT SAFETY DECALS MAY BE OBTAINED FROM YOUR LOCAL DEALER OR BY CALLING TOLL FREE 1-800-872-5726.

DO NOT RUN MACHINE WITHOUT GUARDS IN PLACE

OPERATION & START UP INSTRUCTIONS
OF SLICER SEEDER

THIS MACHINE IS ADJUSTED AT THE FACTORY, HOWEVER, READ AND UNDERSTAND THIS SECTION BEFORE OPERATING.

- A) Be sure that Cutter Raising Lever is in full up position (towards operator).
- B) Be sure to lower front Foot Guard. Blades cannot be adjusted with this guard in "UP" position.
- C) Be sure that Clutch Handles are squeezed into lock position (this will disengage the drive clutches). With motor off try Drive Clutch Handles. Squeeze and push Thumb Lock up with thumb. Drive Clutch Handle should stay in squeezed position. This is neutral. Squeeze and pull thumb Lock towards you letting go of the handle gently. This is drive position. Try a few times to get familiar with this system.
- D) Place switch on motor to "ON" position. Place choke lever (just under air cleaner) to "CHOKER" position if needed and pull cord to start engine. Place throttle lever to low engine speed and return choke lever to normal position. **BE SURE MACHINE IS OVER AREA TO BE SEEDED.** (CHECK CAUTIONS SECTION OF THIS MANUAL).
- E) Be sure to connect electric Kill Switch to your belt on belt loop. This will shut down the machine should you become separated from the unit.

It is a good idea to run machine around the yard a little with the cutter handle in raised position to get a feel for the drive clutches. Once this is done you are ready to move on to the next step.

- F) It would be best to run the machine on bare soil the first time and each time you wish to calibrate the seed meter. Adjust the cutter to the shallowest cutting depth (see Cutter Depth Adjustment). Place the type of seed you wish to calibrate in hopper and choose the seed setting lowest on the scale (about 4-5 to start). Next, lower the cutters and run the machine in a straight line for about 10 feet, raise cutters and stop the machine. Check seed in slot and make any adjustments needed to the seed meter: lower number for less seed, higher number for more seed. When you reach the setting you are pleased with, mark the decal provided. Repeat this procedure with the different types of seed used. You now have a seeding machine that is calibrated to your needs. These procedures will help you and your operators become more familiar with the Slicer Seeder.
- G) Place Cutter Raising Lever to desired cutting depth position (see Cutter Depth Adjustment). Place Seed Adjustment Lever to desired position. Release forward Clutch Lever and check to see if cutting depth and seed amount meet your requirements. Adjust as needed.

***NOTE: ALWAYS LOWER CUTTER LEVER SLOWLY. IF DEPTH IS SET TOO DEEP, LOWERING OF THIS LEVER CAN CAUSE PREMATURE FAILURE OF BELTS OR EVEN CAUSE MACHINE TO LUNGE FORWARD. NEVER LOWER CUTTER HANDLE WITH DRIVE CLUTCHES IN LOCK OR NEUTRAL POSITION.**

DO NOT RUN MACHINE WITHOUT GUARDS IN PLACE

SERVICE SCHEDULE

BE SURE TO DISCONNECT SPARK PLUG
WIRE BEFORE DOING MAINTENANCE ON THE MACHINE!!!

<u>ITEM</u>	<u>FREQUENCY</u>
❖ GREASE FITTING (1).	WEEKLY
❖ CHECK CHAINS AND SPROCKETS FOR ALLIGNMENT (DO NOT LUBRICATE).	DAILY
❖ REMOVE GUARDS AND CHECK BELTS, CHAINS, NUTS, AND BOLTS (CAUTION: NEVER RUN MACHINE WITH GUARDS REMOVED).	WEEKLY
❖ CHECK ENGINE MANUAL FOR ROUTINE MAINTENANCE	

THINK SAFETY

ADJUSTMENTS

1. CUTTER DEPTH ADJUSTMENT

- A. Blade depth can be adjusted from ground level to 2 1/4" deep by turning star knob, Item 7, to the right for less depth or left for more depth.

NOTE: YOU ARE NOT ADVISED TO PLANT SEED DEEPER THAN 1/4 -1/2" BELOW THE THATCH LAYER. PLANTING DEEPER WILL LENGTHEN GERMINATION TIME.

2. SEED ADJUSTMENT

- A. Seed can be adjusted by moving Lever, Item 225, on Hopper to desired location on the scale of 1-10 --- 1 for less, 10 for more. See Operation & Start up instructions in manual.

3. CUTTER BELT ADJUSTMENT

To adjust the Cutter Belt Tension, you must perform the following steps.

NOTE: DO NOT PUT ANY PART OF YOUR BODY UNDER THIS MACHINE AS IT WILL REMOVE IT. DO NOT REACH UNDER IT WITH STICKS OR RODS, IT COULD THROW THEM OUT AT YOU. THIS PIECE OF EQUIPMENT WILL HURT YOU IF YOU DO NOT FOLLOW OUR CAUTIONS. ABOVE ALL

- A. Remove belt guard, Item 148. The motor should be off at this time. We will tell you when to start it.
- B. You will need a piece of plywood about 1/2" thick x 4' x 4'.
- C. Lay plywood down on floor in front of an object that will not move. Example, wall, door, etc.
- D. Push machine on top of plywood in such a way that Roll Bar is up against non-movable object.
- E. Place Drive Clutch Handles, Item 123,, into lock position and depress Lever Locks, Item 124. This will disengage Wheel Drive Belts.
- F. Lower the Cutter Height Handle slowly, Item 142, and be sure Cutters and Wheels, Item 62, are on plywood.
- G. Raise Cutter Handle, Item 142, start engine and set r.p.m. at about 1/3 r.p.m.
- H. Lower Cutter handle, Item 142, slowly so Cutters will engage plywood. Cutters should not stop turning. If they do and Belt begins to slip, raise Cutter Handle, Item 142, and shut down engine.
- I. Remove spark plug wires, turn ON/OFF switch to OFF. Lower Cutter Height Handle, Item 142.
- J. Reach in from Rubber Mud Guard, Item 149, to where Clutch Actuator, Item 46 makes contact with Cutter Housing Adjustment Bolt. Loosen Jam Nuts and Screw Adjusting Bolt up toward the top of the machine (approximately 1/8") Tighten Jam Nut.
- K. Repeat steps G & H. If Belt still slips, repeat steps I & J.
- L. Do not forget to replace Belt Guard, Item 148, before returning seeder to work.

DO NOT RUN MACHINE WITHOUT GUARDS IN PLACE

SERVICE & DISASSEMBLY PROCEDURE

*NOTE: SALSCO USES SELF-LOCKING NUTS AND LOCTITE ON ALL BOLTS. IT IS VERY IMPORTANT

TO FOLLOW THIS PROCEDURE.

- 1)
 - a. Remove spark plug wire.
 - b. Make sure engine switch is in off position.
 - c. Make sure throttle is in stop position
 - d. Shut off gas.
 - e. Drop Cutter Height Lever so cutters are at ground level.

- 2) TO REPLACE CUTTER BLADES:
 - a. Remove both Locknuts, Item 143 from Cutter Raise Bar, Item 151.
 - b. Remove Guard, Item 148.
 - c. Remove Drive Belts, Item 18, Spring, Item 106 and Clutch Link Bolt, Item 49.
 - d. Remove 6 Bolts, Item 28 that mount Cutter Housing Assembly to Main Housing. CAUTION: DO NOT LOOSEN, ITEM 31.
 - e.
 1. Remove Cutter Housing Assembly from Main Housing. All of it will slide out at this time.
 2. Remove Drive Chain, Item 96.
 - f. Loosen Bearing Bolts, item 77 on sprocket side of Housing & remove Bearing Bolts, Item 77 on other side
 - g. Slide free end of Cutter Shaft from Housing with sprocket end remaining in Housing.
 - h. Remove Screw, Item 70 from Shaft, Item 87. Bearing, Item 74, Spacers, Items 75 & 88, and Cutter Blades, Item 76, can be slid off Shaft & replaced.
 - i. Clean all parts and check for wear at this time.
 - j. As you begin to reassemble, check direction of cutting before putting blades back in.

NOTE: TO REASSEMBLE, REVERSE PROCEDURE: TO REASSEMBLE, AFTER ALL BLADES AND SPACERS ARE ON, TIGHTEN SCREW, ITEM 70, ON END OF CUTTER SHAFT. BE SURE TO USE LOCTITE ON THIS BOLT. DO NOT FORGET TO REPLACE GUARD.

3) TO REPLACE SEED DISCS SHAFT ASSEMBLY

- a. Remove Guard, Item 163
- b. Remove Master Link from Chain, Item 164
- c. Remove Bearing Bolts, Item 188
- d. Remove Shaft Assembly, Item 165

NOTE: TO REASSEMBLE, REVERSE PROCEDURE. REPLACE GUARD

4) TO REPLACE CUTTER DRIVING BELTS

- a. Be sure that Cutter Height Handle, Item 142, is in "UP" position.
- b. Remove Guard, Item 148.
- c. Belts, Item 18, can be slid off Pulleys & replaced.
- d. Belt can be adjusted. (See Section CUTTER BELT ADJUSTMENT, this manual. BE SURE YOU PUT THE GUARD BACK.

"CAUTION: CUTTER BLADES SHOULD NOT TURN WHEN HEIGHT HANDLE IS IN "UP" POSITION.

SERVICE & DISASSEMBLY PROCEDURE – Continued

- 5) TO REPAIR OR REPLACE SEED METERING PLATES
- a. Remove Chain Guard, Item 163, and Chain, Item 164.
 - b. Turn Lock Plates Item 166 & 167.
 - c. Remove Hopper upwards from Lower Housing. (GOOD TIME TO CLEAN)
 - d. Remove Shutoff Plate, Item 219, from hopper, remove 14 Bolts, Item 214 and remove Seed Meter Plates, Items 215, 221, 222, & 223 from Hopper.
 - e. Inspect Metering Plates and Wear Plate to be sure they are clear of all debris and seed. BE SURE TO PUT THE GUARD BACK ON.

TO ASSEMBLE, REVERSE PROCEDURE. BE SURE TO USE A SILICONE TO SEAL SEAMS AND OPEN AREA INSIDE HOPPER.

Saisco, Inc.
 LEADER BY DESIGN
 105 SCHOOL HOUSE ROAD
 CHESHIRE, CONNECTICUT 06410

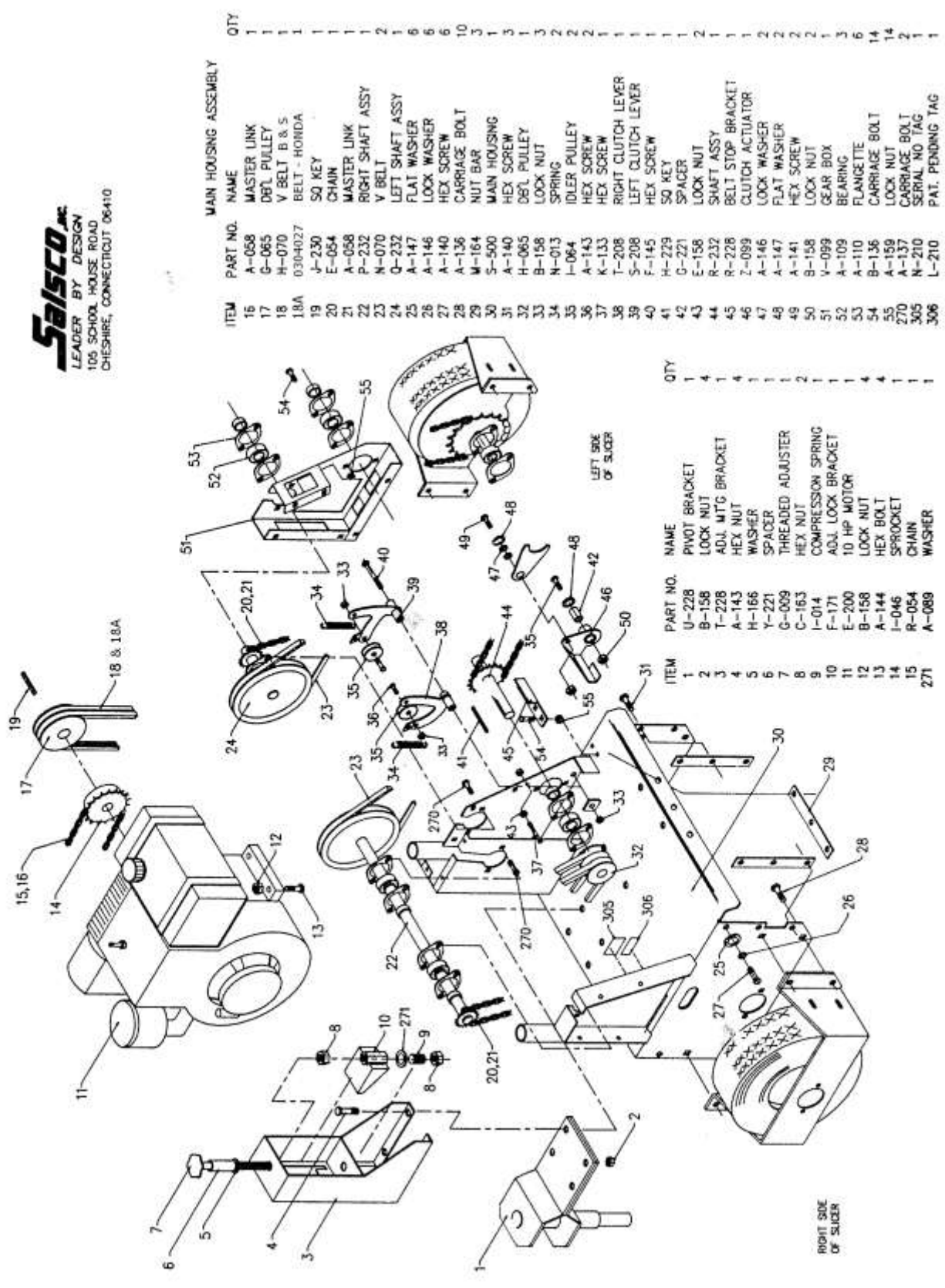

ITEM	PART NO.	NAME	QTY
16	A-058	MASTER LINK	1
17	G-065	DBL PULLEY	1
18	H-070	V BELT B & S	1
18A	0304027	BELT - HONDA	1
19	J-230	SO KEY	1
20	E-054	CHAIN	1
21	A-058	MASTER LINK	1
22	P-232	RIGHT SHAFT ASSY	1
23	N-070	V BELT	2
24	Q-232	LEFT SHAFT ASSY	1
25	A-147	FLAT WASHER	6
26	A-146	LOCK WASHER	6
27	A-140	HEX SCREW	6
28	A-136	CARRIAGE BOLT	10
29	M-164	NUT BAR	3
30	S-500	MAIN HOUSING	1
31	A-140	HEX SCREW	3
32	H-065	DBL PULLEY	1
33	B-158	LOCK NUT	3
34	N-013	SPRING	2
35	I-064	IDLER PULLEY	2
36	A-143	HEX SCREW	2
37	K-133	HEX SCREW	2
38	T-208	RIGHT CLUTCH LEVER	1
39	S-208	LEFT CLUTCH LEVER	1
40	F-145	HEX SCREW	1
41	H-229	SO KEY	1
42	G-221	SPACER	1
43	E-158	LOCK NUT	2
44	R-232	SHAFT ASSY	1
45	R-228	BELT STOP BRACKET	1
46	Z-099	CLUTCH ACTUATOR	1
47	A-146	LOCK WASHER	2
48	A-147	FLAT WASHER	2
49	A-141	HEX SCREW	2
50	B-158	LOCK NUT	2
51	V-099	GEAR BOX	1
52	A-109	BEARING	3
53	A-110	FLANGETTE	6
54	B-136	CARRIAGE BOLT	14
55	A-159	LOCK NUT	14
270	A-137	CARRIAGE BOLT	2
305	N-210	SERIAL NO TAG	1
306	L-210	PAT. PENDING TAG	1

ITEM	PART NO.	NAME	QTY
1	U-228	PIVOT BRACKET	1
2	B-158	LOCK NUT	4
3	T-228	ADJ. MTG BRACKET	1
4	A-143	HEX NUT	4
5	H-166	WASHER	1
6	Y-221	SPACER	1
7	G-009	THREADED ADJUSTER	1
8	C-163	HEX NUT	1
9	I-014	COMPRESSION SPRING	2
10	F-171	ADJ. LOCK BRACKET	1
11	E-200	10 HP MOTOR	1
12	B-158	LOCK NUT	4
13	A-144	HEX BOLT	4
14	I-046	SPROCKET	1
15	R-054	CHAIN	1
271	A-089	WASHER	1

Saisco, Inc.
 LEADER BY DESIGN
 105 SCHOOL HOUSE ROAD
 CHESHIRE, CONNECTICUT 06410

REMOVABLE HOUSING ASSEMBLY

ITEM	PART NO.	NAME	QTY
91	B-136	CARRIAGE BOLT	8
92	B-110	FLANGETTE	8
93	B-109	BEARING	4
94	A-159	LOCK NUT	9
95	N-232	DRIVE SHAFT	1
96	C-054	DRIVE CHAIN	1
97	B-058	MASTER LINK	1
98	F-230	SO KEY	1
99	T-500	REMOVABLE HOUSING	1
100	F-065	DOUBLE PULLEY	1
101	N-100	CLUTCH LEVER	1
102	A-081	SET COLLAR	1
103	A-136	CARRIAGE BOLT	1
104	B-145	HEX BOLT	1
105	B-158	LOCK NUT	2
106	D-013	EXTENSION SPRING	1
107	A-147	FLAT WASHER	8
108	L-064	IDLER PULLEY	2
109	A-146	LOCK WASHER	2
110	G-231	CLUTCH LINK	1
111	A-122	BUSHING	2

CUTTER HOUSING ASSEMBLY

ITEM	PART NO.	NAME	QTY
70	D-131	BUTTON HEAD SCREW	2
71	A-146	LOCK WASHER	2
72	C-135	FLAT WASHER	2
73	A-110	FLANGETTE	4
74	A-109	BEARING	2
75	A-089	FLAT WASHER	2
76	A-205	CUTTER BLADE	10
77	B-136	CARRIAGE BOLT	4
78	U-500	CUTTER HOUSING	1
79	H-158	LOCK NUT	1
80	A-147	WASHER	2
81	A-113	BEARING	1
82	B-144	HEX BOLT	1
83	B-229	SO KEY	1
84	A-159	LOCK NUT	4
85	A-142	HEX SCREW	1
86	H-146	BEVEL WASHER	1
87	M-232	CUTTER SHAFT	1
88	F-069	SPACER	8
89	X-221	SPACER	1
90	D-046	SPROCKET	1
117	A-163	HEX NUT	1
118	B-158	LOCK NUT	1
307	I-210	DECAL MADE W/PRIDE	1
308	C-210	DECAL DANGER	2

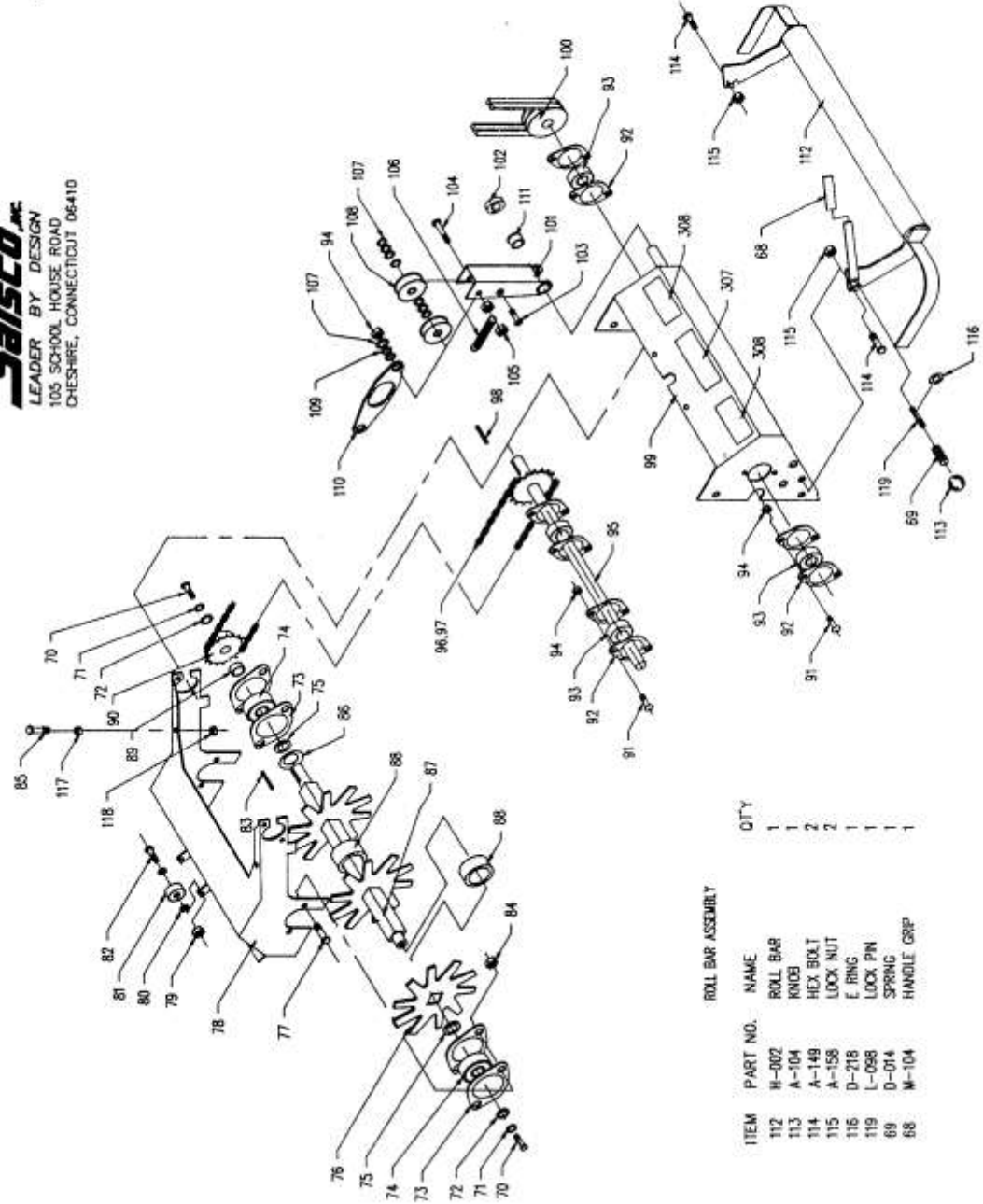

ROLLER BAR ASSEMBLY

ITEM	PART NO.	NAME	QTY
112	H-002	ROLL BAR	1
113	A-104	KNOB	1
114	A-149	HEX BOLT	2
115	A-158	LOCK NUT	2
116	D-218	E RING	1
119	L-056	LOCK PIN	1
69	D-014	SPRING	1
68	M-104	HANDLE GRP	1

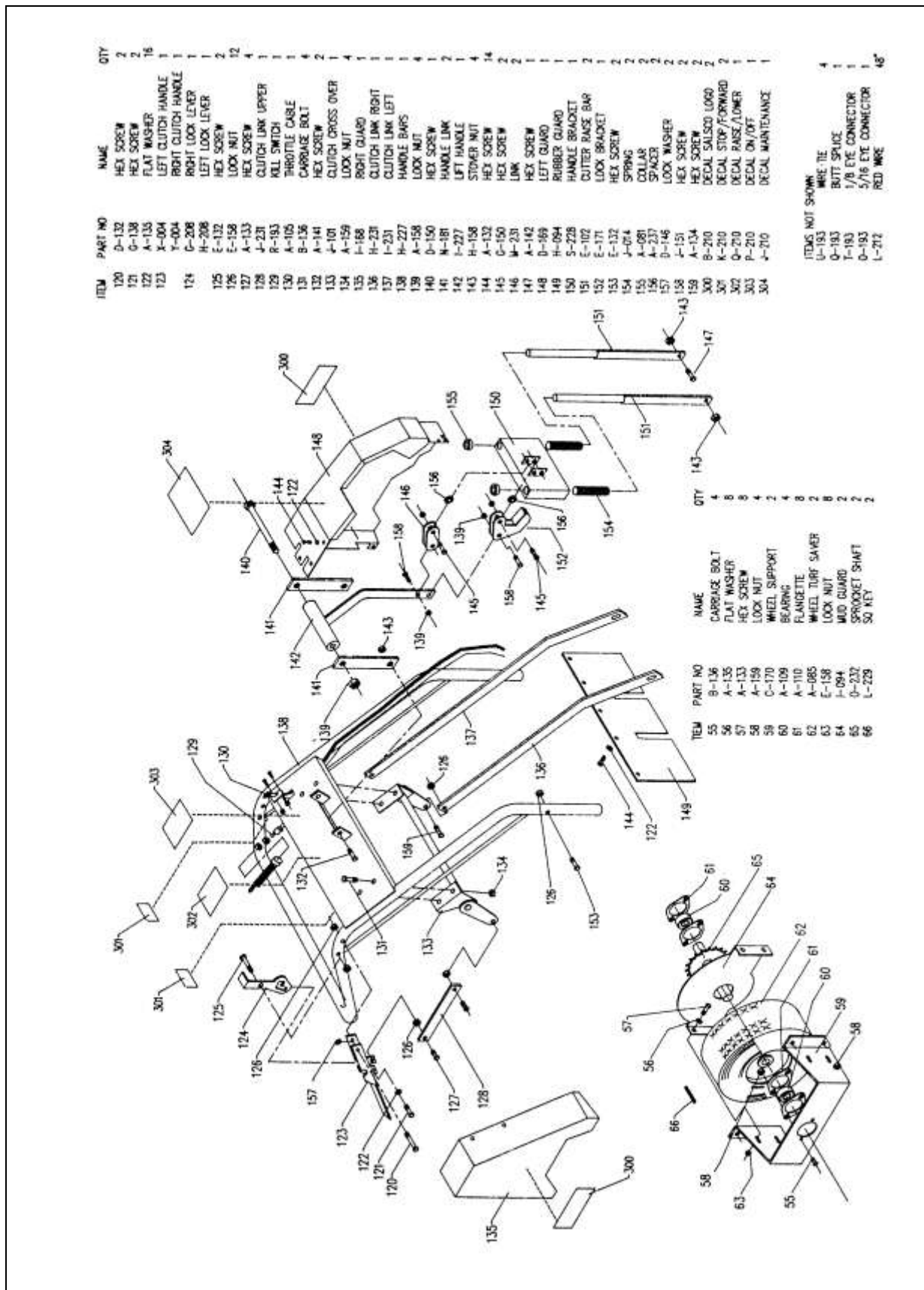

ITEM	PART NO	NAME	QTY
120	D-132	HEX SCREW	2
121	G-138	FLAT WASHER	2
122	A-135	RIGHT CLUTCH HANDLE	16
123	X-004	LEFT CLUTCH HANDLE	1
124	Y-004	RIGHT CLUTCH HANDLE	1
125	H-208	RIGHT LOCK LEVER	1
126	E-132	LEFT LOCK LEVER	2
127	E-158	LOCK NUT	12
128	A-133	HEX SCREW	4
129	J-231	CLUTCH LINK UPPER	1
130	R-183	CLUTCH LINK LOWER	1
131	A-105	KILL SWITCH	1
132	B-136	THRUSTLE CABLE	1
133	A-141	CARRIAGE BOLT	4
134	J-101	HEX SCREW	2
135	A-159	CLUTCH CROSS OVER	1
136	H-188	LOCK NUT	4
137	H-231	RIGHT GUARD	1
138	I-231	CLUTCH LINK RIGHT	1
139	H-227	CLUTCH LINK LEFT	1
140	A-158	HANDLE BARS	4
141	D-150	LOCK NUT	1
142	M-181	HEX SCREW	2
143	I-227	HANDLE LINK	1
144	H-158	LEFT HANDLE	1
145	A-132	STOYER NUT	4
146	G-150	HEX SCREW	14
147	M-231	LINK	2
148	A-142	HEX SCREW	1
149	D-189	LEFT GUARD	1
150	H-084	RUBBER GUARD	1
151	S-228	HANDLE BRACKET	1
152	E-102	CUTTER PACE BAR	2
153	E-171	LOCK BRACKET	1
154	E-132	HEX SCREW	2
155	J-014	SPRINGS	2
156	A-081	DOLLAR	2
157	A-237	SPACER	2
158	D-146	LOCK WASHER	2
159	J-151	HEX SCREW	2
160	A-134	HEX SCREW	2
161	B-210	DECAL SALSOLO LOGO	2
162	K-210	DECAL STOP/FORWARD	2
163	Q-210	DECAL RAISE/DLOWER	1
164	P-210	DECAL ON/OFF	1
165	J-210	DECAL MAINTENANCE	1

ITEM	PART NO	NAME	QTY
55	B-136	CARRIAGE BOLT	4
56	A-135	FLAT WASHER	8
57	A-133	HEX SCREW	8
58	A-158	LOCK NUT	4
59	C-170	WHEEL SUPPORT	2
60	A-109	BEARING	4
61	A-110	FLANGETTE	8
62	A-085	WHEEL TURF SAVER	2
63	E-158	LOCK NUT	8
64	J-094	MOD GUARD	2
65	D-232	SPROCKET SHAFT	2
66	L-229	SQ KEY	2

ITEMS NOT SHOWN
 WIRE TIE 4
 BUTT SPALICE 1
 1/8 EYE CONNECTOR 1
 5/16 EYE CONNECTOR 1
 RED WIRE 45

Saisco, Inc.
 LEADER BY DESIGN
 105 SCHOOL HOUSE ROAD
 CHESHIRE, CONNECTICUT 06410

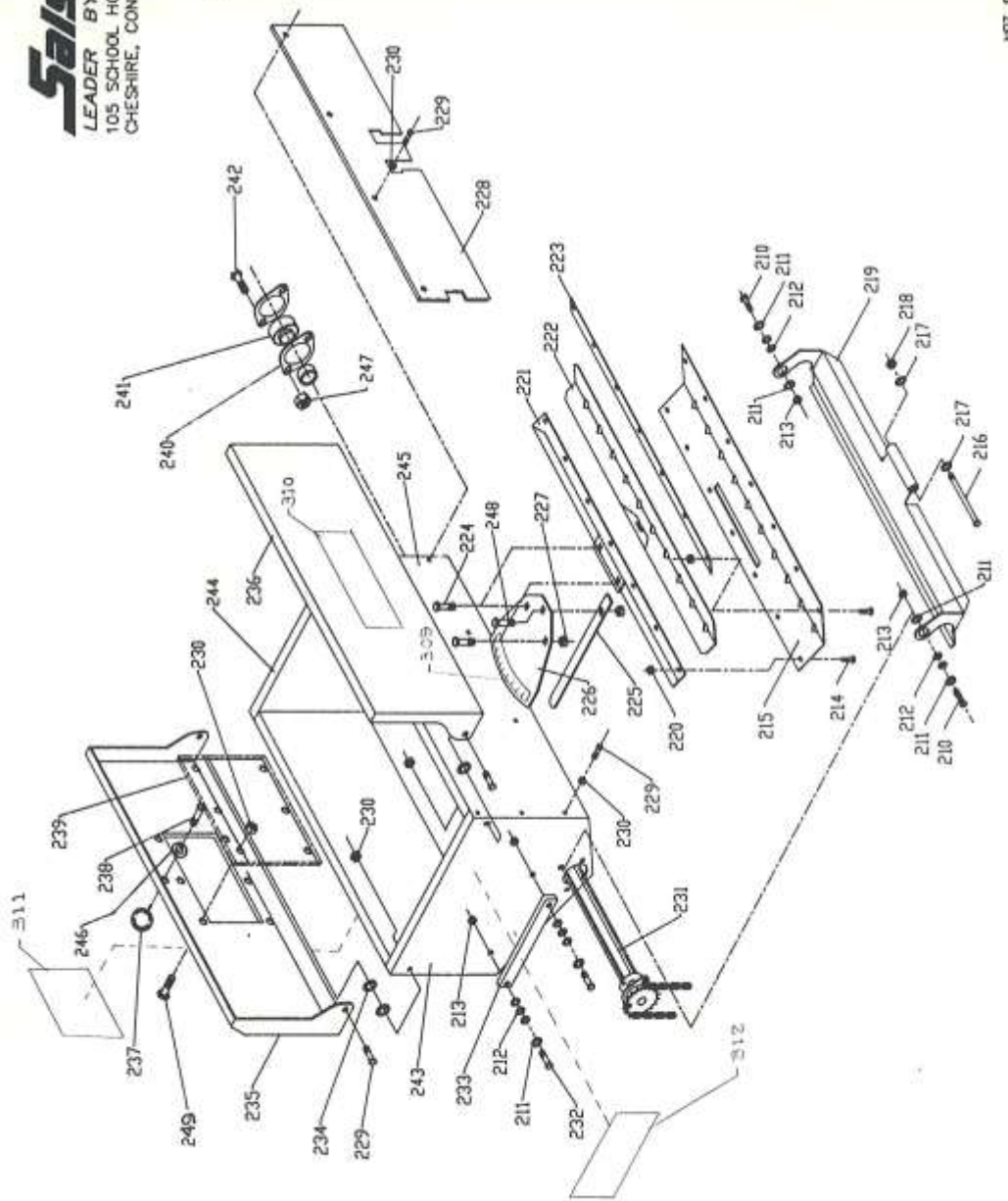

ITEM	NO	NAME	QTY
210	A-141	HEX SCREW	2
211	A-147	FLAT WASHER	8
212	A-146	LOCK WASHER	16
213	B-158	LOCK NUT	6
214	J-133	HEX SCREW	14
215	J-506	SLIDE RET'G PLATE	1
216	E-145	HEX SCREW	1
217	A-147	FLAT WASHER	2
218	B-158	LOCK NUT	1
219	P-506	SHUT OFF PLATE	1
220	E-158	LOCK NUT	14
221	K-506	SLIDE SPACER PLATE	1
222	M-506	SLIDE METER PLATE	1
223	L-506	SPACER PLATE	1
224	B-136	CARRIAGE BOLT	2
225	D-208	METER LEVER	1
226	B-209	METER PLATE	1
227	A-159	LOCK NUT	1
228	G-234	MUD SHIELD	3
229	J-133	HEX SCREW	30
230	E-158	LOCK NUT	30
231	L-232	AGITATING SHAFT	1
232	A-142	HEX SCREW	4
233	J-166	SPACER PLATE	2
234	A-135	FLAT WASHER	6
235	Q-506	HOPPER DOOR V/WINDOW	1
236	S-506	HOPPER DOOR	1
237	B-104	KNOB	1
238	B-140	HEX SCREW	7
239	A-207	WINDOW	1
240	C-100	FLANGETTE	2
241	C-109	BEARING	1
242	J-133	HEX SCREW	4
243	D-506	LEFT END PLATE	1
244	M-506	RIGHT END PLATE	1
245	R-506	HOPPER PLATE	1
246	B-146	LOCK WASHER	1
247	E-158	LOCK NUT	4
248	G-138	HEX SCREW	1
249	Y-094	FOAM STRIP	1
249	Z-094	FOAM PAD	1
249	A-152	HEX SCREW	6
309	M-225	DECAL METER	1
310	L-210	DECAL PRIDE	1
311	R-210	DECAL CHART	1
312	L-225	DECAL 355	2

NOT SHOWN
 NUT SHOWN

Saisco, Inc.
LEADER BY DESIGN
 105 SCHOOL HOUSE ROAD
 CHESHIRE, CONNECTICUT 06410

ITEM NO	NAME	QTY
161	A-132 HEX SCREW	3
162	B-146 LOCK WASHER	3
163	F-234 CHAIN GUARD	1
164	T-054 DRIVE CHAIN	1
165	N-076 DISC SHAFT ASSY	1
166	K-505 RIGHT LOCK PLATE	2
167	L-505 LEFT LOCK PLATE	2
168	B-093 SCRAPER	10
169	E-158 LOCK NUT	10
170	B-014 SPRING	10
171	D-132 HEX SCREW	10
172	Y-099 PIVOT PLATE	1
173	C-138 HEX SCREW	2
174	W-099 ACTUATING PLATE	2
175	A-159 LOCK NUT	3
176	X-099 ACTUATING PLATE	1
177	J-133 HEX SCREW	2
178	A-159 LOCK NUT	4
179	C-138 HEX SCREW	4
180	A-158 LOCK NUT	2
181	B-147 WASHER	2
182	Q-089 SPACER	2
183	B-084 WHEEL	2
184	B-151 HEX SCREW	1
185	A-159 LOCK NUT	4
186	A-109 BEARING	1
187	A-110 FLANGETTE	2
188	B-136 HEX SCREW	4
189	Z-221 SPACER	1
190	U-208 WHEEL LEVER	1
191	L-231 WHEEL LINK	1
192	F-013 SPRING	1
193	B-158 LOCK NUT	5
194	A-163 HEX NUT	2
195	A-147 FLAT WASHER	3
196	A-146 LOCK WASHER	3
197	A-144 HEX SCREW	1
198	A-163 LOCK NUT	1
199	V-096 HOPPER LOCK ASSY	1
200	Q-228 PIVOT BRACKET	1
201	B-158 LOCK NUT	5
202	A-142 HEX SCREW	5
203	A-121 BUSHING	2
204	A-106 GREASE FITTING	1
205	A-142 HEX SCREW	1
206	A-079 COLLAR	1
207	A-143 HEX SCREW	2
208	C-145 HEX SCREW	1
209	C-151 HEX SCREW	1
260	V-500 HOPPER BASE	1
261	B-146 LOCK WASHER	2
262	A-135 FLAT WASHER	2
263	Q-013 SPRING	1
264	G-221 SPACER	1
265	L-104 HANDLE GRIP	1
266	D-146 LOCK WASHER	4
267	K-135 WAVE WASHER	8
268	A-163 HEX NUT	1

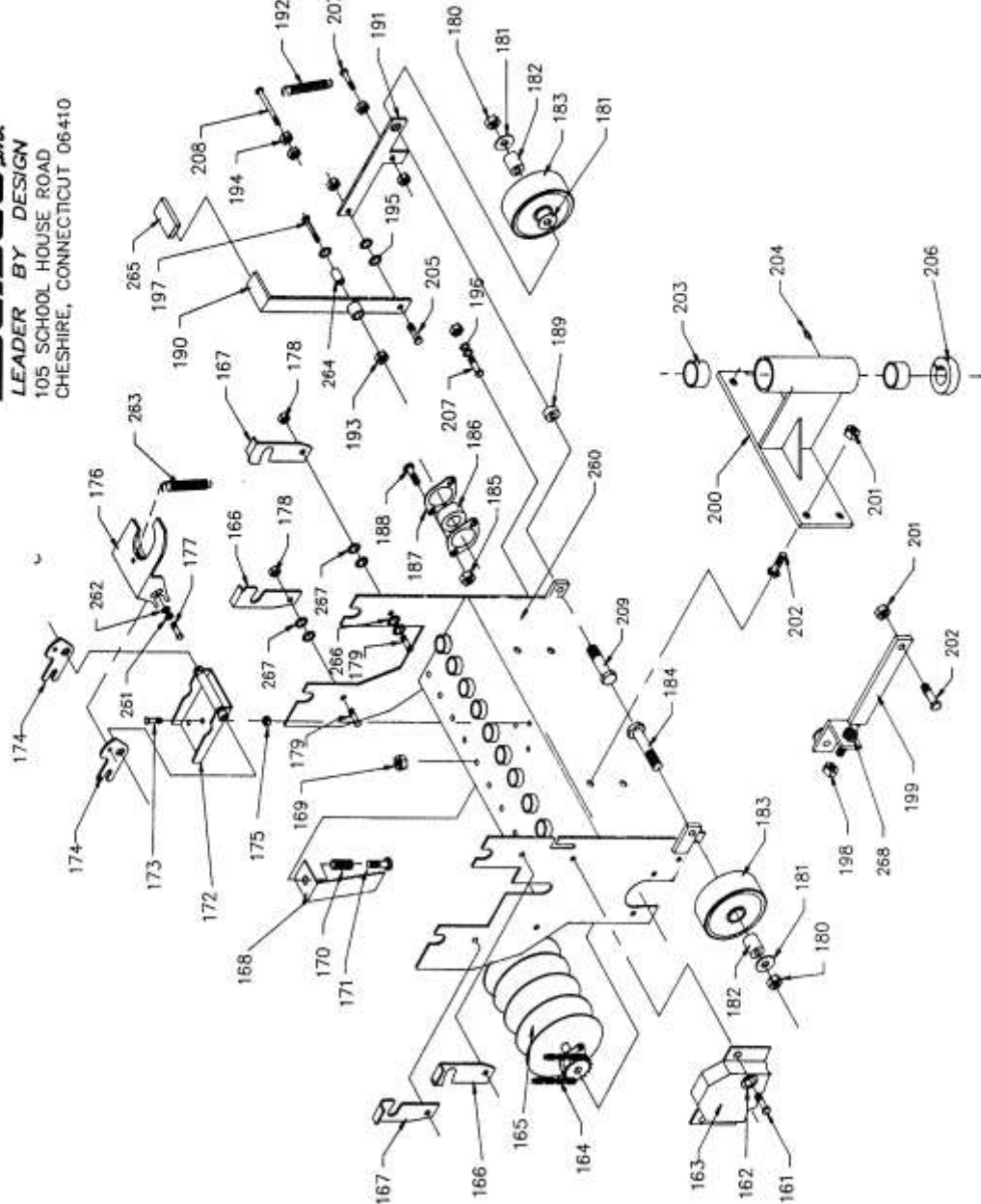

Below is a quick reference chart for various “Flat Head Cap Screws” and the torque recommendations.

VALUES ARE STATED IN FOOT POUNDS

BOLT SIZE	Thds Per Inch	SAE Grade 5	SAE Grade 8
1/4	20	10	14
	28	---	---
5/16	18	19	29
	24	---	---
3/8	16	33	47
	24	---	---
7/16	14	54	78
	20	---	---
1/2	13	78	119
	20	---	---
9/16	12	114	169
	18	---	---
5/8	11	154	230
	11	---	---
3/4	10	257	380
	10	---	---
7/8	9	382	600
	9	---	---
1	8	587	700
	8	---	---

Drive Belt Tension Measurement by Deflection

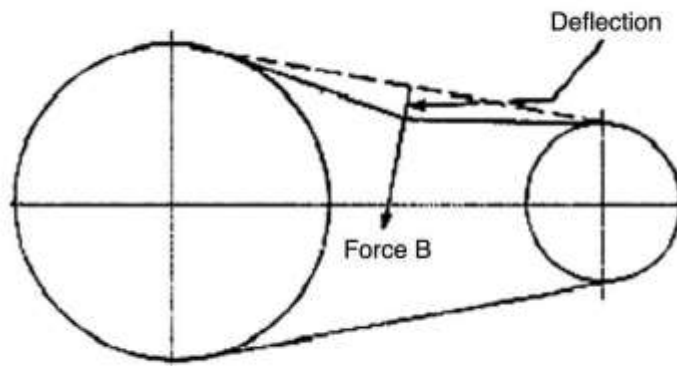

Deflection should be 3/8" when 8-12 lbs. push is applied at "B"

WARRANTY POLICY

Please remember to complete and return your Warranty Card and Dealer Delivery Report. Warranty Claims will not be considered if the Warranty Card and Dealer Delivery Report have not been returned to Salsco.

Your Salsco Commercial or Turf Equipment product is a commercial type product and is normally manufactured and sold for commercial or industrial use. **Salsco will, for the original purchaser, for one (1) year from the date of purchase (90 days if used for rental purposes) repair or replace, free of charge, any SALSCO part or parts found to be defective in material, workmanship or both.** Any transportation or shipping charges will be borne by the purchaser. If, during the warranty period stated above, the product does not function properly due to defect, simply contact Salsco and follow the Warranty Procedures included in this manual.

This warranty **does not** include:

- Incidental or consequential damages and is exclusive of any implied warranties.
- Normal maintenance parts, including, but not limited to hoses, chains, belts, filters, lubricants, etc.
- Parts or components, which are covered under the original manufacturer warranty, including, but not limited to engines, pumps, and motors.

WARRANTY PROCEDURE

In order for Salsco to consider your warranty claims in a timely manner you must follow the simple procedures listed below:

MACHINE OR PART FAILURE

- Call our service department for helpful instruction on how to correct or repair the problem. Preventive maintenance will also be suggested.
- When ordering parts for Warranty issues, you **MUST** retain possession of the old parts in question until notified with respect to returning the parts to Salsco or other disposition.
- Warranty Claims **MUST** be filed within 30-days from completion of the work performed. Contact our office for an electronic warranty claim form.
- Fill in all information requested on warranty claim form, a copy of which is included in this manual, (date of purchase, company name, address, etc.). List all parts used. Make sure part numbers are correct. You can obtain these from your manual. (include good description of problem; i.e. "leaking from spool" rather than "leaking").
- It is our goal to consider and reach a disposition on each Warranty Claim within 30-days from the date that it is received. Therefore it is important that you respond promptly to any request for further information. Claims with no response to inquiries will be closed as "**denied for lack of response**" 90-days from the date of request.
- Email, Fax or Send Warranty Claim form to our Warranty Department. – **Warranty on parts most often requires return of the parts that were replaced. DO NOT DISCARD OLD PARTS UNTIL YOU HAVE RECEIVED A DETERMINATION AS TO WHETHER THESE PARTS MUST BE RETURNED.**
- Our Warranty Department will contact and instruct you on how to return the Parts to Salsco on an RA #. Returns **MUST** be made within 30-Days from issuance of RA #. **FREIGHT CHARGES ON RETURN OF PARTS IS THE RESPONSIBILITY OF THE CUSTOMER.** Normal pre-delivery adjustments are not covered under warranty. Labor Warranties are based on reasonable time allowances as determined by Salsco, Inc. and paid at 75% of posted labor rate. **TRAVEL TIME IS NOT REIMBURSED UNDER THE WARRANTY POLICY.**
- Be sure to put the RA form inside the box that you are shipping back, also be sure to put on the outside of the box "Return of Goods" and the RA #.
- Ship returns via a traceable method such as UPS Ground Service. Be sure that the shipment is insured for the appropriate value. If uninsured parts are lost, we cannot issue a credit.

PLEASE NOTE: ***Warranty forms should be filled out completely.***

PREVENTIVE MAINTENANCE IS YOUR BEST INSURANCE AGAINST EQUIPMENT FAILURE. BE SURE TO READ THIS MANUAL, ESPECIALLY THE MAINTENANCE, OPERATING AND CAUTION SECTIONS.

SALSCO, INC., 105 School House Rd.
Cheshire, CT 06410
800-872-5726, 203-271-1682
203-271-2596 (Fax)
sales@salsco.com, www.salsco.com

WARRANTY CLAIM FORM

SALSCO, INC.
105 School House Rd.
Cheshire, CT 06410

Phone:(203) 271-1682,(800) 872-5726
Fax: (203) 271-2596
Email: s.clark@salsco.com
Website: www.salsco.com

END OWNER

Date Submitted:

Name:	Phone:	Work Order #:
Email:	Fax:	Office Use Only
Address:		Date Rec'd
		Cust ID:
		Salsco WC
		Salsco RA

PURCHASED FROM

Name:	Phone:	Date Approved:
Email:	Fax:	Date Rejected:
Address:		Processed By:
		Dir. Del Report on File: YES NO
		Warranty Card on File: YES NO
		Part(s) Total:

Equipment/Warranty Information (Must be complete)

Purchase Date:	Invoice #	Date Failed:	Labor Total:
			Total Approved:
Model #:	Serial #:	Repair Date:	Approved/Rejected:
			Name:
Hrs Used:	Primary Use:		Reason for Rejection:
Warranty Claim/Work Order#:			

Was a Salsco Return Authorization # issued for repairs or

Return of Parts? YES NO	Suggested Preventative Maint:
Probable Cause of Failure:	

Work Performed/Comments on Repair:

Shop Labor Rate:						Submitted By:		
Total Labor Hours to Repair:						Printed Name:		
Parts Required for repair								
Salsco Part #: Description:					Qty.	Price Each	Total	Inv #
							\$	
							\$	
							\$	
							\$	

Fill in all information requested on warranty claim form.
INCOMPLETE FORMS CANNOT BE PROCESSED & WILL BE RETURNED
List all parts used. Make sure part numbers are correct. Any parts that you believe to be defective or any parts that break should be retained for possible inspection until after the warranty has been paid or part has been replaced.

